

## SMB Series

SMB 系列产品是按照 MIL-C-39012、IEC169-10 详细规范研制生产的一种小型推入锁紧式射频同轴连接器，具有体积小、质量轻、使用方便、电性能优良等特点，适用于无线电设备和电子仪器的高频回路中连接射频同轴电缆用。

The SMB series are snap-on-latched coupling miniature coaxial connectors which are produced according to the specifications of MIL-C-39012 and IEC 169-10. They have the characteristics of light weight, small size, convenient connection, excellent electrical and mechanical properties, are always suitable to connect coaxial cables in RF circuits of electronic equipment.

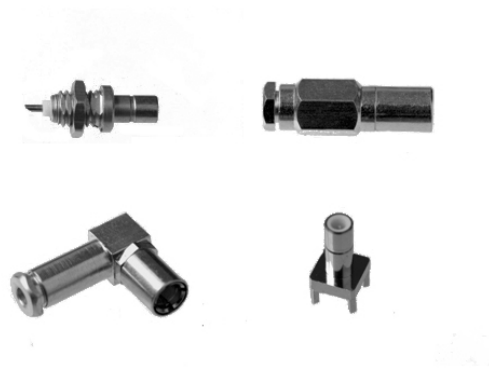

# 金润信电子科技有限公司

## 主要技术特性 Technical Characteristics:

环境温度范围 Temperature range	-65~+165℃	
<b>电气性能 Electrical Characteristics</b>		
特征阻抗 Characteristic impedance	50Ω	
工作电压 Working voltage	250V max(有效值)	
频率范围 Frequency range	0~4GHz	
介质耐压 Dielectric withstanding voltage	海平面 at sea level: 750V(volts RMS)	
接触电阻 Contact resistance	内导体 center contact	≤6.0mΩ
	外导体 Outer contact	≤1.0mΩ
绝缘电阻 Insulation resistance	≥5000MΩ	
电压驻波比 VSWR	直式 straight	≤1.34
	弯式 right - angle	
<b>材料与涂覆 Mechanical Characteristics</b>		
壳体和其它金属零件 Body or other metallic parts	黄铜镀金或镍 Brass, gold / nickel plated	
插针 Male center contacts:	黄铜镀金 Brass, gold plated	
插孔 Female center contacts:	铍青铜镀金 Beryllium copper, gold plated	
绝缘体 Insulators:	聚四氟乙烯 PTFE	
压接套 Crimp ferrules:	铜合金镀镍或镀金 Copper alloy, nickel or gold plated	
密封件 Sealing washer	硅橡胶 Silicone rubber	
连接器机械耐久性 Connector durability	500 次 Cycles	

### 界面尺寸 Interface Mating Dimensions

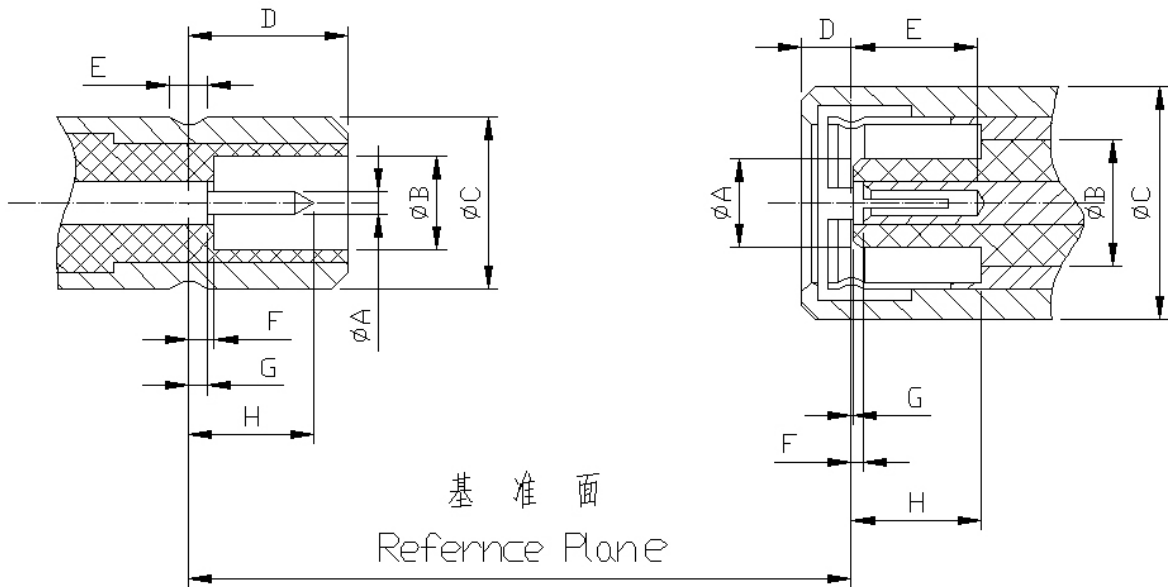

	PLUG (mm)	
	MIN	MAX
A	0.48	0.53
B	2.08	-
C	3.66	3.71
D	3.33	3.58
E	0.69	0.94
F	-	0.18
G	-	0.18
H	-	2.97

	JACK (mm)	
	MIN	MAX
A	2	2.06
B	3.05	-
C	6.4	-
D	2.97	-
E	-	1.63
F	0.18	0.94
G	0.18	-
H	3.58	-

## SMB Series

### 电 缆 连 接 器 Connectors for Cable



SMB-J3

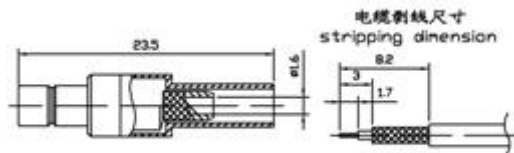

产品型号	电缆型号	备注
SMB-J3	SFF-50-1.5-1 RG316/U	



SMB-J3A

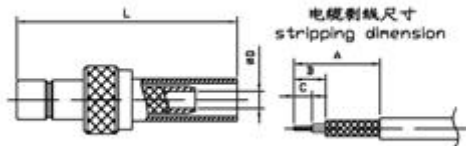

产品型号	电缆型号	D	L	A	B	C
SMB-J3A	SFF-50-1.5-1 RG316/U	01.6	21	11.0	4.5	2.5
SMB-J5A	SFF-50-3-2 RG223/U	03.1	23.7	13.0	5.5	2.5



SMB-JB2

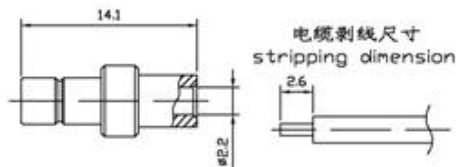

产品型号	电缆型号	备注
SMB-JB2	SFT-50-2-1 RG405/U	



SMB-JF3A

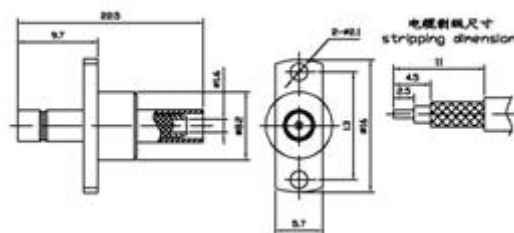

产品型号	电缆型号	备注
SMB-JF3A	SFF-50-1.5-1 RG316/U	



SMB-JW2

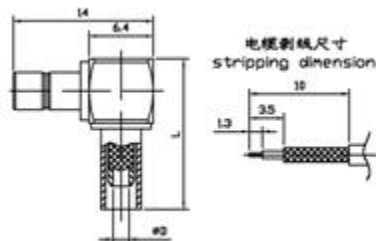

产品型号	电缆型号	D	L	A	B
SMB-JW2	SFF-50-1 RG178/U	13.7	00.9	10.0	3.5
SMB-JW3	SFF-50-1.5-1 RG316/U	15.1	01.6	11.0	5.0



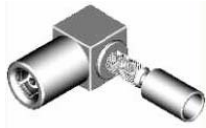

SMB-KW2

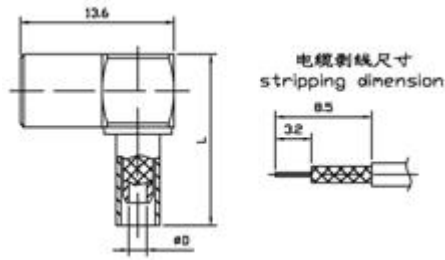

产品型号	电缆型号	D	L	备注
SMB-KW2	SFF-50-1 RG178/U	00.9	13.7	
SMB-KW3	SFF-50-1.5-1 RG316/U SYV-50-2-1	01.6	13.1	
SMB-KW4	SFF-50-2-1	02.3	15.8	
SMB-KW5	SFF-50-3-1 SYV-50-3	03.1	19.8	



SMB-KWB2

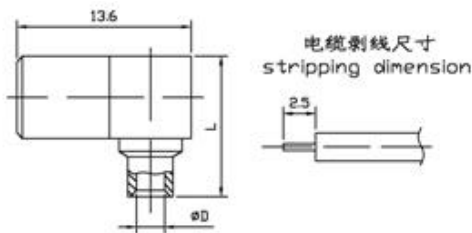

产品型号	电缆型号	L	D
SMB-KWB2	SFT-50-2-1 RG405/U	11.5	02.2
SMB-KWB3	SFT-50-3-1 RG402/U	10.9	03.6



SMB-KY3

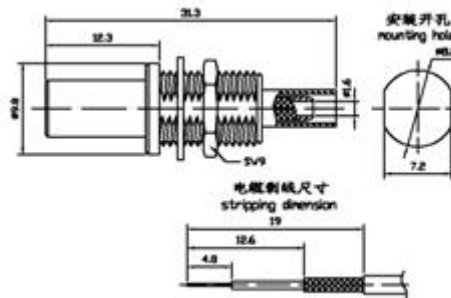

产品型号	电缆型号	备注
SMB-KY3	SFF-50-1.5-1 RG316/U	

法兰安装式微带连接器  
Flange Connectors with Micro-Strip



SMB-JFD

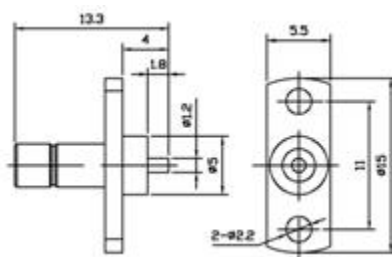

SMB-JFD21

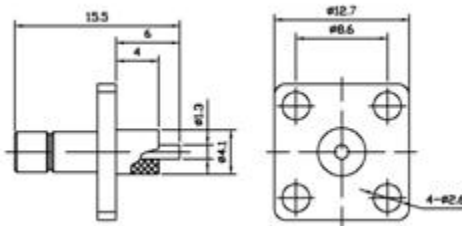



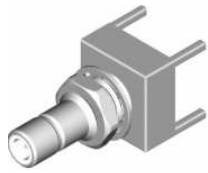

SMB-JYHD

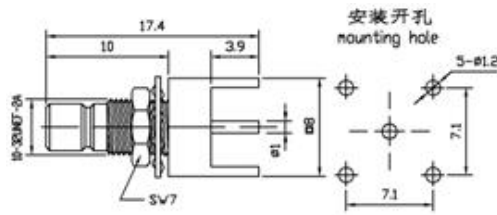

SMB-JWHD

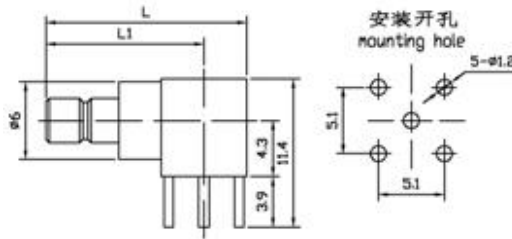

产品型号	L	L1
SMB-JWHD	15.5	12.3
SMB-JWHD1	21.6	18.4
SMB-JWHD2	13.7	10.5
SMB-JWHD10	15.5	12.3



SMB-JWHY

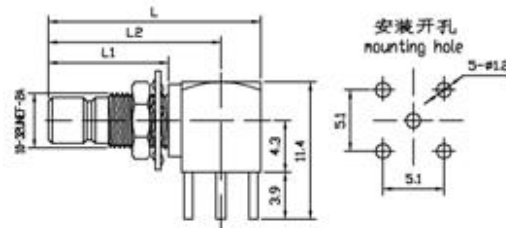

产品型号	L	L1	L2	备注
SMB-JWHY	17.9	10.5	14.7	
SMB-JWHY1	21.6	14.2	18.4	

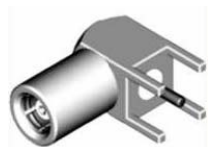

SMB-KWHD

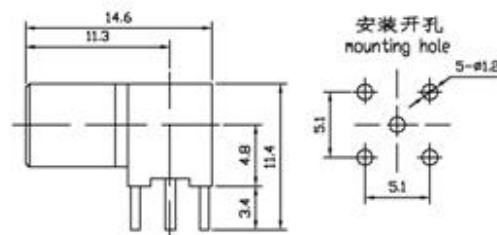

SMB-KHD

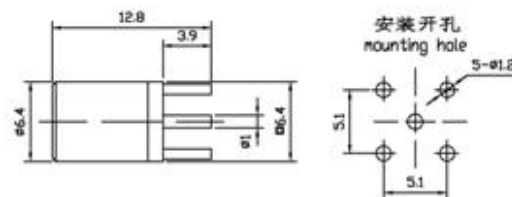

产品型号	L	L1
SMB-KHD	12.8	3.9



系列内转接器  
Within-Series Adapters



SMB-JJ

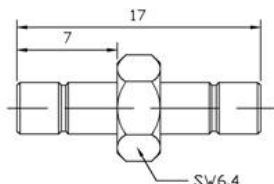

SMB-JJY

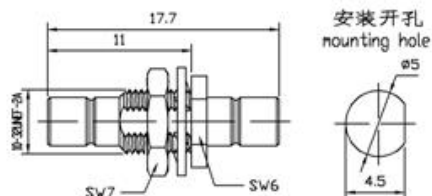

SMB-KJ

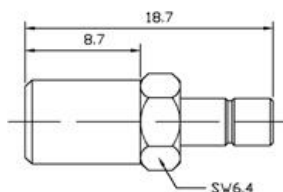

SMB-KK

