

## SMA Series

SMA 系列产品是一种应用广泛的小型螺纹连接的同轴连接器,符合标准 MIL-C-39012、IEC169-15 的相关规定,寿命长、性能优越、可靠性高。广泛用于微波设备和数字通信设备的射频回路中连接射频同轴电缆或微带。

The SMA series are very popular screw coupling miniature coaxial connectors, which are developed and produced according to the relative specifications of MIL-C-39012 and IEC169-15. They have the characteristics of high reliability, high mechanical stability, long life, and optimum electrical properties, are widely used to connect RF coaxial cables for microwave equipment and electronic communication instruments.

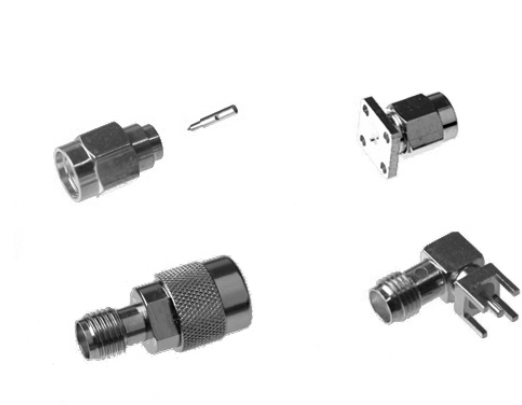

# 金润信电子科技有限公司

主要技术特性 Technical Characteristics:		
环境温度范围 Temperature range	-65~+165°C	
<b>电气性能 Electrical Characteristics</b>		
特征阻抗 Characteristic impedance	50Ω	
工作电压 Working voltage	335V max(有效值)	
频率范围 Frequency range	软电缆 flexible cables: 0~12.4GHz; 半刚电缆 semi-rigid cables: 0~18GHz	
介质耐压 Dielectric withstanding voltage	海平面 at sea level: 1000V(volts RMS)	
接触电阻 Contact resistance	内导体 center contact	≤3.0mΩ
	外导体 Outer contact	≤2.0mΩ
绝缘电阻 Insulation resistance	≥5000MΩ	
电压驻波比 VSWR	直式 straight	接软性电缆 flexible cables≤1.15+0.02f
		接半刚电缆 semi-rigid cables≤1.05+0.01f
	弯式 right - angle	接软性电缆 flexible cables≤1.20+0.03f
		接半刚电缆 semi-rigid cables≤1.10+0.01f
<b>材料与涂覆 Mechanical Characteristics</b>		
壳体和其它金属零件 Body or other metallic parts	黄铜镀金或镍或不锈钢表面钝化 Brass, gold / nickel plated or stainless steel passivity	
插针 Male center contacts:	黄铜镀金 Brass, gold plated	
插孔 Female center contacts:	铍青铜镀金 Beryllium copper, gold plated	
绝缘体 Insulators:	聚四氟乙烯 PTFE	
压接套 Crimp ferrules:	铜合金镀镍或镀金 Copper alloy, nickel or gold plated	
连接器机械耐久性 Connector durability	500 次 Cycles	

### 界面尺寸 Interface Mating Dimensions

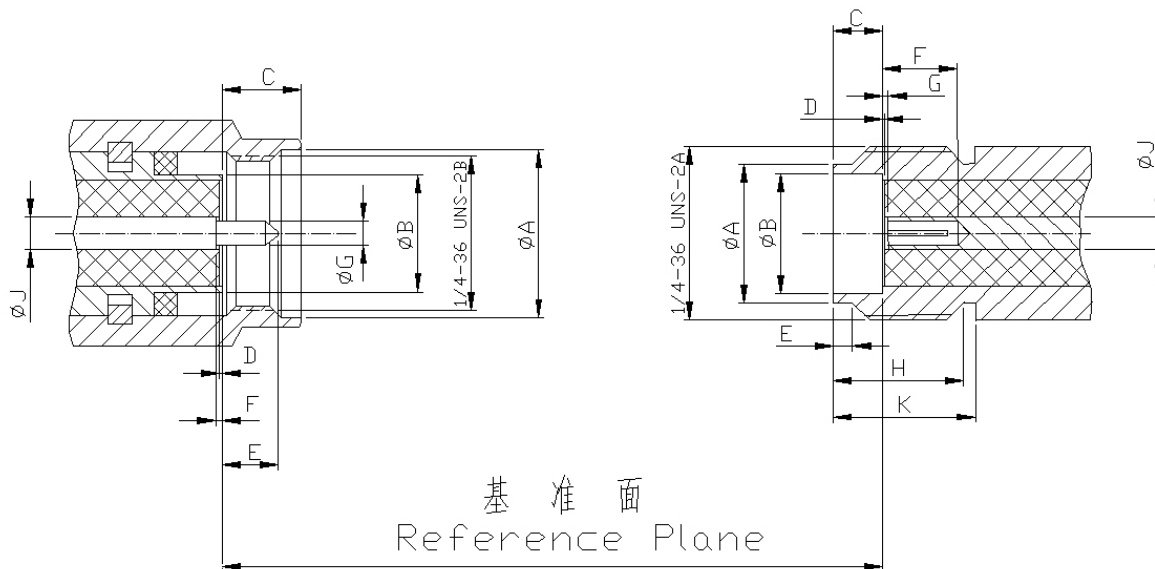

	PLUG (mm)	
	MIN	MAX
A	6.35	6.73
B	4.53	4.59
C	2.54	3.43
D	0.00	0.18
E	1.91	2.54
F	0.00	0.25
G	0.90	0.94
J	1.24	1.30

	JACK (mm)	
	MIN	MAX
A	5.28	5.49
B	4.60	4.70
C	1.88	1.98
D	0.00	0.18
E	0.38	1.14
F	2.92	-
G	0.00	0.25
H	4.32	-
J	1.24	1.30
K	5.54	-

## SMA Series

### 软 电 缆 连 接 器 Connectors for Flexible Cables



SMA-J2

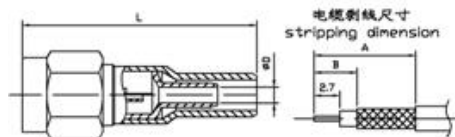

产品型号	电缆型号	D	L	A	B	备注
SMA-J2	SFF-50-1 RG178/U	Ø0.9	22.7	10.7	4.5	
SMA-JH113	Dia. 1.13mm	Ø1.3	22.7	10.7	4.5	
SMA-J3B	SFF-50-1.5-1 RG316/U	Ø1.6	23.5	10.7	4.5	
SMA-J4A	SFF-50-2-2	Ø2.3	25	10.7	4.5	线夹 镀金
SMA-J4B						
SMA-J5C	SFF-50-3-1 SYV-50-3	Ø3.1	27.5	12.7	4.78	



SMA-J3

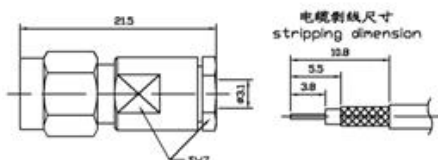

产品型号	电缆型号	L	D	备注
SMA-J3	SFF-50-1.5-1 RG316/U	21.5	3.1	外壳、螺 套、螺母 镀三元合
SMA-J3H				
SMA-J5E	SFF-50-1.5-1 RG58/U RG316/U LMR195	22.9	5.2	装接式



SMA-J3Y

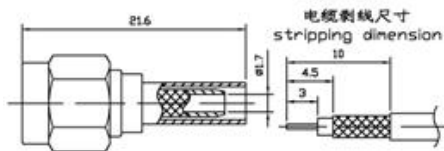

产品型号	电缆型号	备注
SMA-J3Y	SFF-50-1.5-1 RG174/U RG316/U LMR100	
SMA-J3YN		外壳、螺套镀镍
SMA-J3YH		外壳、螺套镀三元合金
SMA-J3YG		不锈钢螺套



SMA-J3YF

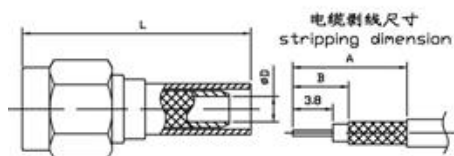

产品型号	电缆型号	D	L	A	B
SMA-J3YF	SFF-50-1.5-1 RG174/U RG316/U LMR100	Ø1.6	25.5	11.8	5.3
SMA-J4Y	SFF-50-2-1	Ø2.3	23.7	14.8	7.3
SMA-J5Y	SFF-50-3-1 RG58/U RG141A/U LMR195	Ø3.1	28.7	16.3	5.8
SMA-J5YF					



SMA-J204Y

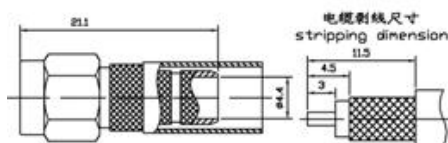

产品型号	电缆型号	备注
SMA-J204Y	SFF-50-1.5-1 RG174/U RG316/U LMR400	

# 金润信电子科技有限公司



SMA-J400Y

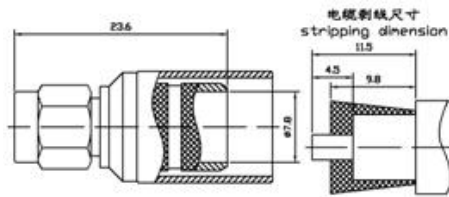

产品型号	电缆型号	备注
SMA-J400Y	SFF-50-1.5-1 RG174/U RG316/U LMR400	



SMA-JW113

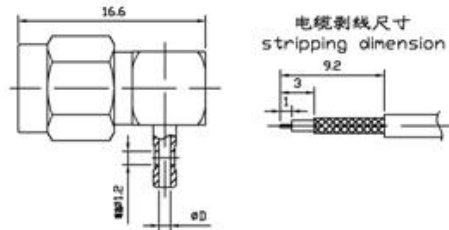

产品型号	电缆型号	D	备注
SMA-JW113	Dai. 1.13mm	Ø1.2	
SMA-JW178	SFF-50-1 RG178/U	Ø1.5	

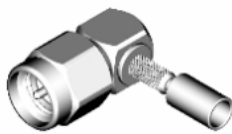

SMA-JW2Y

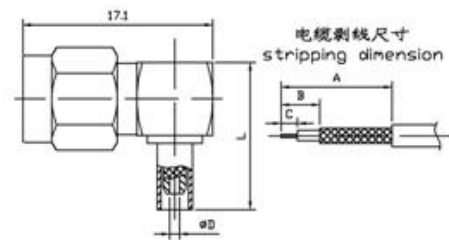

产品型号	电缆型号	A	B	C	D	L
SMA-JW2Y	SFF-50-1 RG178/U	10.0	3.5	1.5	Ø0.9	13.2
SMA-JH178						
SMA-JW3Y	SFF-50-1.5-1 RG316/U LMR100	11.0	5.0	1.5	Ø1.7	15.3
SMA-JW3YA	RG316DT					
SMA-JW4Y	SFF-50-2-1	13.5	5.0	2.0	Ø2.3	17.4
SMA-JW4-1Y	SFF-50-2-2					
SMA-JW5Y	SFF-50-2-1 RG58/U LMR195	15.5	5.0	2.0	Ø3.2	22.3
SMA-JW223Y	RG223/U					
SMA-JW5YA	SFF-50-3-2 RG142B/U					



SMA-K3Y

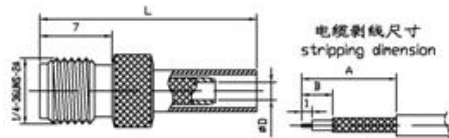

产品型号	电缆型号	D	L	A	B
SMA-K3Y	SFF-50-1.5-1 RG316/U	Ø1.6	20.0	107	4.7
SMA-K4Y	SFF-50-2-1	Ø2.3	22.0	12.7	4.2
SMA-K5Y	SFF-50-3-1 RG58/U LMR195	Ø3.1	27.0	15.4	8.2
SMA-K5YG		Ø3.1	27.0	15.4	8.2



SMA-K3YA

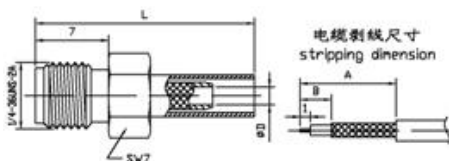

产品型号	电缆型号	D	L	A	B
SMA-K3YA	SFF-50-1.5-1 RG316/U	Ø1.6	20.0	107	4.7
SMA-K4YA	SFF-50-2-1	Ø2.3	22.0	12.7	4.2
SMA-K5YA	SFF-50-3-1 RG58/U LMR195	Ø3.1	27.0	15.4	8.2
SMA-K5YG		Ø3.1	27.0	15.4	8.2

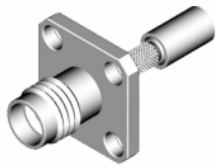

SMA-KF3Y

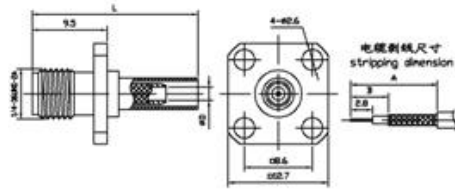

产品型号	电缆型号	L	D	A	B	备注
SMA-KF3Y	SFF-50-1.5-1 RG316/U	19.9	Ø1.6	10.0	3.5	线夹 镀金
SMA-KF3YB	RG-316DT LMR100	19.4				
SMA-KF4Y	SFF-50-2-1	21.9	Ø2.3	13.3	5.3	
SMA-KF5Y	SFF-50-3-1 RG58/U RG-141A/U LMR195	26.9	Ø3.1	15.3	4.8	

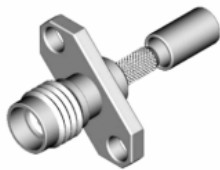

SMA-KF3Y-2

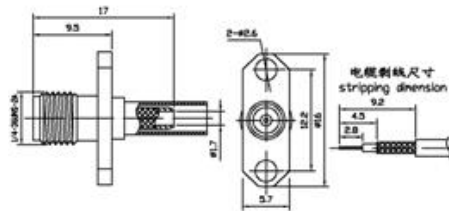

产品型号	电缆型号	备注
SMA-KFY3-2	RG-316DT LMR100	-2 表示两孔法兰

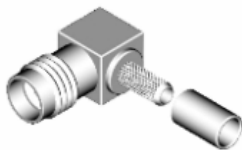

SMA-KW3Y

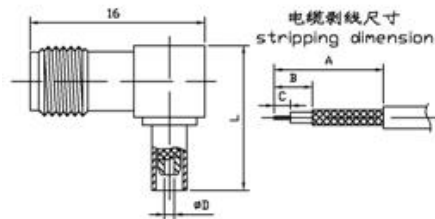

产品型号	电缆型号	A	B	C	D	L
SMA-KW2Y	SFF-50-1	10.0	3.5	1.5	Ø0.9	13.2
SMA-KH178	RG178/U					
SMA-KW3Y	SFF-50-1.5-1 RG316/U LMR100 RG316DT	11.0	5.0	1.5	Ø1.7	15.3
SMA-KW4Y	SFF-50-2-1 SFF-50-2-2	13.5	5.0	2.0	Ø2.3	17.4
SMA-JW5Y	SFF-50-3-1 RG58/U LMR195	15.5	5.0	2.0	Ø3.2	22.3



SMA-KYH178

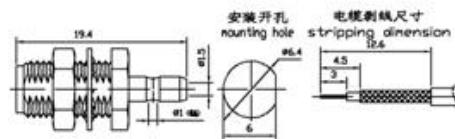

产品型号	电缆型号	A	B
SMA-KYH178	SFF-50-1 RG178/U	6.7	3.1
SMA-KYH113	Di.a.1.13mm	3.1	3.8



SMA-KY3Y

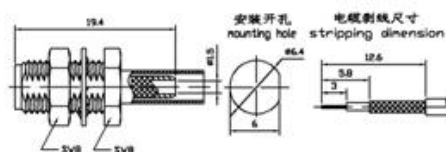

产品型号	电缆型号	备注
SMA-KY3Y	SFF-50-1.5-1 RG316/U	带密封圈
SMA-KY3YG	LMR100	不锈钢外壳 螺母铜镀镍





SMA-KB2

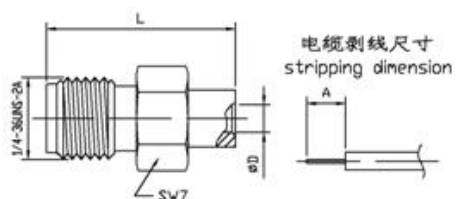

产品型号	电缆型号	D	L	A
SMA-KB2	SFT-50-2-1	Ø2.2	15	3.0
SMA-KB2A	RG405/U		13.5	
SMA-KB3	SFT-50-3-1 RG402/U	Ø3.6	15	
SMA-KB5	SFT-50-5.2-1	Ø6.1	19.6	4.0
SMA-KB5A	1/4" cable	Ø6.5		



SMA-KFB2-2

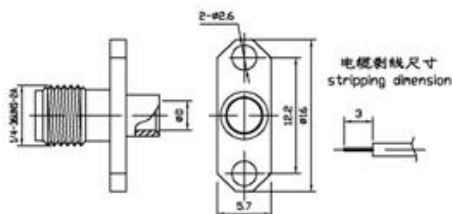

产品型号	电缆型号	D	备注
SMA-KFB2-2	SFT-50-2-1 RG405/U	Ø2.27	
SMA-KFB3-2	SFT-50-3-1 RG402/U	Ø3.67	



SMA-KFB2

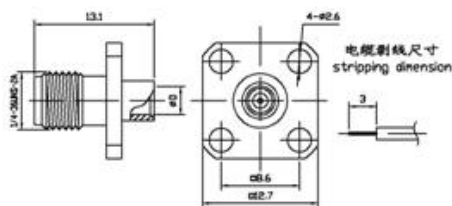

产品型号	电缆型号	D	备注
SMA-KFB2	SFT-50-2-1	Ø2.27	
SMA-KFB3	SFT-50-3-1 RG402/U	Ø3.67	



SMA-KYB2

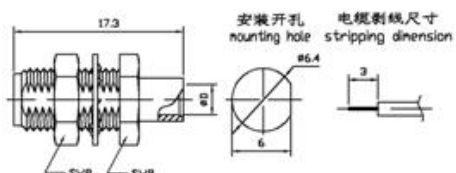

产品型号	电缆型号	D	备注
SMA-KYB2	SFT-50-2-1 RG405/U	Ø2.2	
SMA-KYB3	SFT-50-3-1 RG402/U	Ø3.6	

印制板安装连接器

Connectors for PC Board Mounting



SMA-JHD

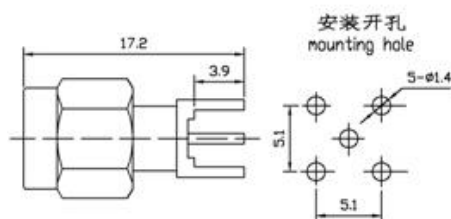



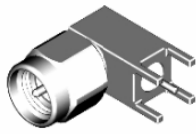

SMA-JWHD

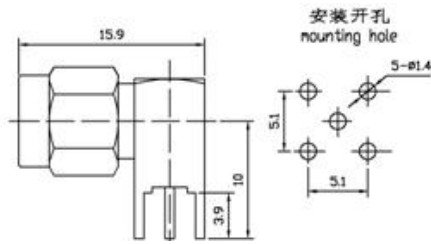

SMA-KHD

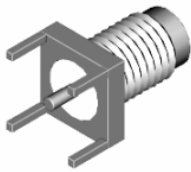
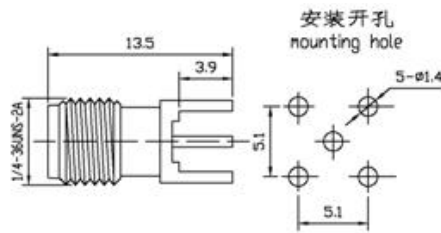

SMA-KHD1

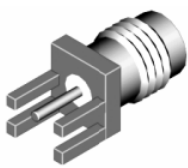
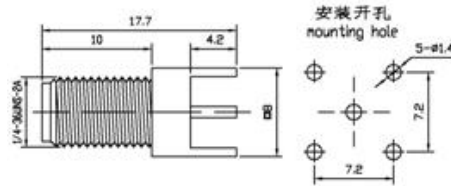

SMA-KHD2

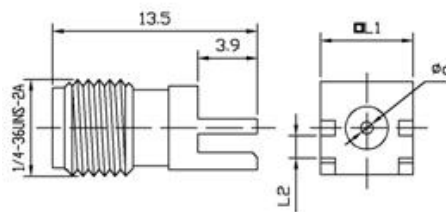

产品型号	L1	L2	d
SMA-KHD2	6.1	1.5	Ø1.3
SMA-KHD3	6.7	2.2	Ø0.8
SMA-KHD5	6.5	2.0	Ø0.8
SMA-KHD12	6.7	2.5	Ø0.3

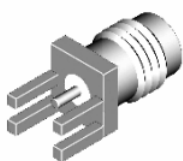

SMA-KHD6

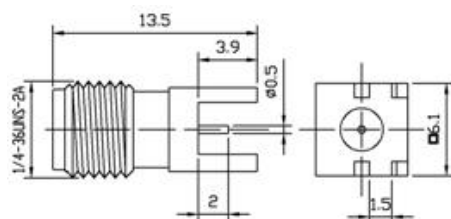

产品型号	L1	L2	d
SMA-KHD2	6.1	1.5	Ø1.3
SMA-KHD3	6.7	2.2	Ø0.8
SMA-KHD5	6.5	2.0	Ø0.8
SMA-KHD12	6.7	2.5	Ø0.3

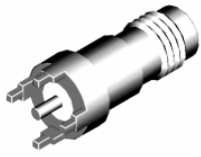

SMA-KHD11

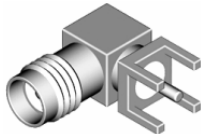
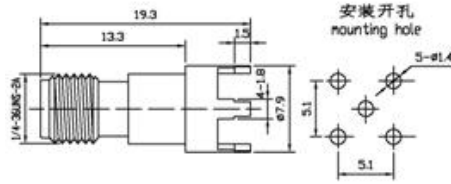

SMA-KWHD

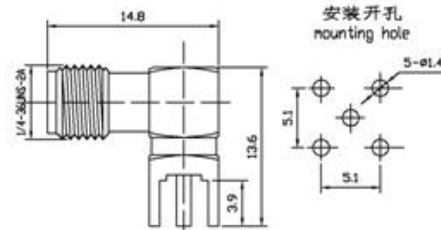

法兰安装式微带连接器  
Flange Connectors with Micro-Strip

四孔法兰 4-Flange



SMA-JFD5

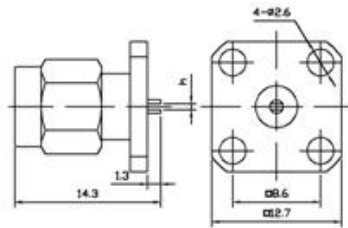

产品型号	h	备注
SMA-JFD5	0.5	
SMA-JFD9	0.2	



SMA-JFD6

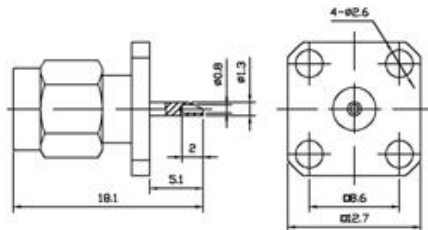

SMA-JFD10

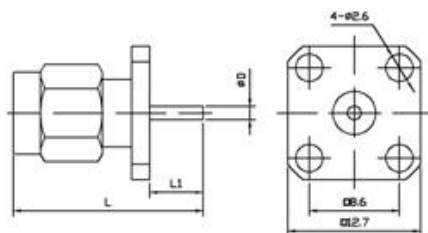

产品型号	L	L1	D	备注
SMA-JFD10	17.0	4.0	Ø1.3	
SMA-JFD24	14.6	1.6	Ø0.9	
SMA-JFD25	14.2	1.2	Ø0.8	
SMA-JFD25A	13.9	0.9	Ø0.5	
SMA-JFD78	14.6	1.6	Ø0.7	



SMA-JFD15

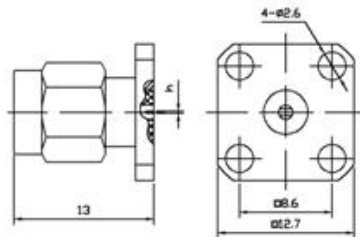

SMA-JFD33

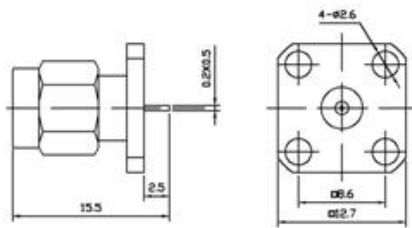

SMA-KFD

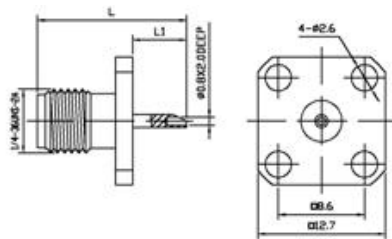

产品型号	L	L1	备注
SMA-KFD	14.7	5.2	
SMA-KFD65	12.5	3.0	



SMA-KFD1

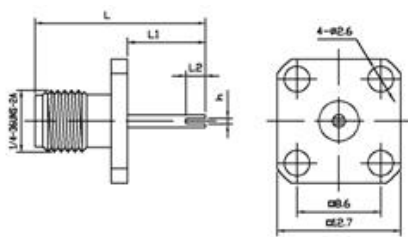

产品型号	L	L1	L2	h
SMA-KFD1	17.5	8.0	1.4	0.6
SMA-KFD2	12.0	2.4	1.6	0.6
SMA-KFD18	12.0	2.5	1.6	0.2
SMA-KFD35	10.6	1.0	1.0	0.4
SMA-KFD36	10.6	1.0	1.0	0.2
SMA-KFD38	10.8	1.3	1.3	0.7

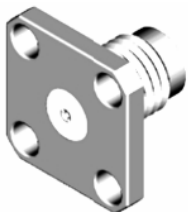

SMA-KFD26

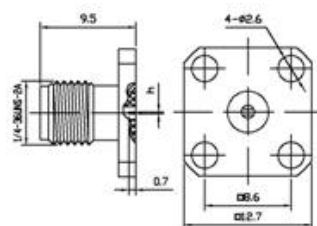

产品型号	h	备注
SMA-KFD26	0.2	内导体尾部开槽
SMA-KFD27	0.4	

# 金润信电子科技有限公司

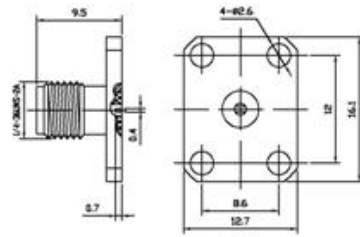
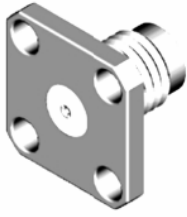

SMA-KFD27Z

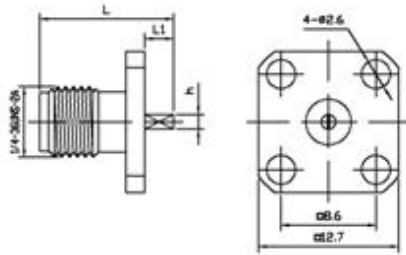

SMA-KFD32

产品型号	L	L1	h
SMA-KFD32	16.1	2.5	1.3×0.2
SMA-KFD33	10.9	1.4	1.3×0.2
SMA-KFD39	12.1	2.6	0.5×0.2
SMA-KFD39A	12.1	2.6	1.0×0.2

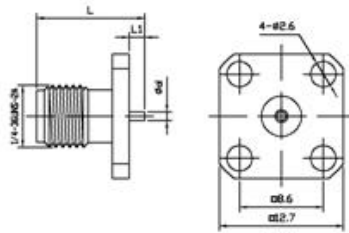
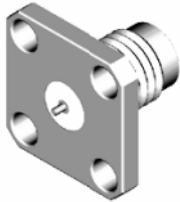

SMA-KFD47

产品型号	L	L1	d	备注
SMA-KFD47	11.1	1.6	Ø0.9	
SMA-KFD48	10.7	1.2	Ø0.8	
SMA-KFD48A	10.4	0.9	Ø0.6	
SMA-KFD78	11.0	1.5	Ø0.7	
SMA-KFD88	14.1	1.5	Ø0.5	
SMA-KFD380	10.4	0.9	Ø0.6	

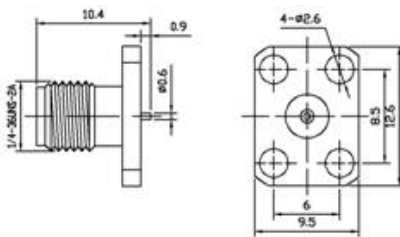

SMA-KFD48B

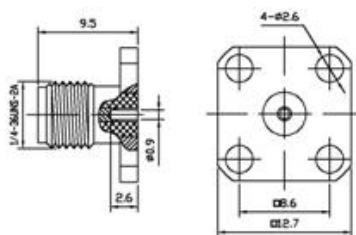
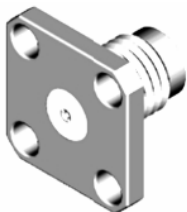

SMA-KFD53

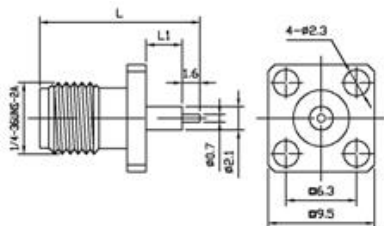
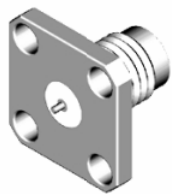

产品型号	L	L1	备注
SMA-KFD68DX	14.3	3.2	
SMA-KFD68DX-1	11.1	0	
SMA-KFD68DX-2	15.1	4.0	

SMA-KFD68DX

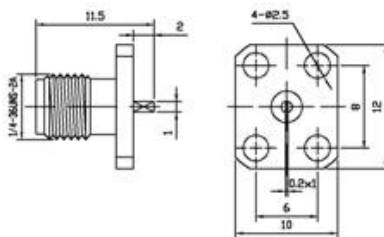

产品型号	备注
SMA-KFD387	扁与长边平行

SMA-KFD387

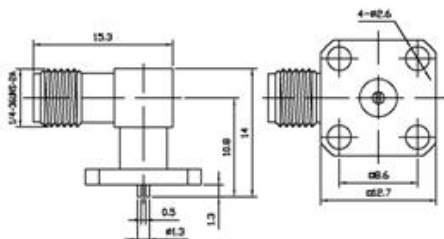
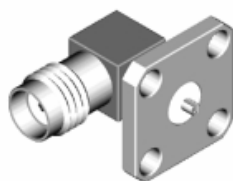

SMA-KWFD

## 四孔法兰、介质穿墙类 4-Flange & Mail Wall

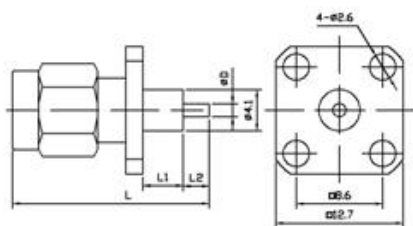

SMA-JFD11

产品型号	L	L1	L2	D
SMA-JFD11	19.4	2.4	4.0	1.3
SMA-JFD12	23.4	8.4	2.0	1.3
SMA-JFD13	25.4	8.4	4.0	1.3
SMA-JFD14	17.6	4.0	0.6	0.4
SMA-JFD34	25.0	8.4	4.0	1.3
SMA-JFD35	25.0	5.0	4.5	1.3
SMA-JFD37	22.4	7.5	2.0	1.3

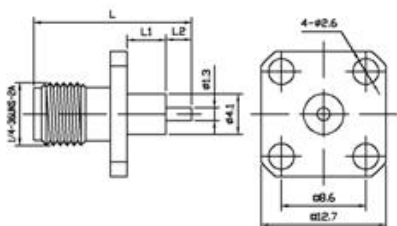
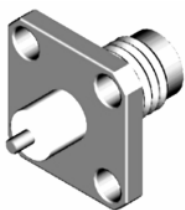

SMA-KFD5

产品型号	L	L1	L2	产品型号	L	L1	L2
SMA-KFD5	15.5	4.0	2.0	SMA-KFD307	17.0	5.0	2.5
SMA-KFD6	20.5	9.0	2.0	SMA-KFD347	20.5	4.0	7.0
SMA-KFD22	27.5	15.0	3.0	SMA-KFD359	18.0	4.0	4.5
SMA-KFD43	21.5	4.0	8.0	SMA-KFD390	16.0	5.0	1.5
SMA-KFD83	14.5	2.5	2.5	SMA-KFD411	22.0	1.5	11.0
SMA-KFD85	27.5	13.0	5.0	SMA-KFD412	23.5	12.0	2.0
SMA-KFD85A	25.5	13.0	3.0	SMA-KFD8413	18.0	5.5	3.0
SMA-KFD227	18.5	5.0	4.0	SMA-KFD414	25.3	8.8	7.7
SMA-KFD228	20.5	8.0	3.0	SMA-KFD415	27.4	15.0	2.9
SMA-KFD246	17.5	4.0	4.0				



SMA-KFD13

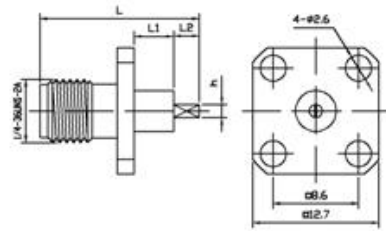

产品型号	L	A	B	h
SMA-KFD13	16.1	4.0	2.6	0.5×0.2
SMA-KFD335	13.0	2	1.5	1.0×0.2
SMA-KFD253	15.7	3.2	3.0	1.3×0.2

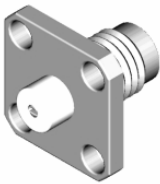

SMA-KFD28B

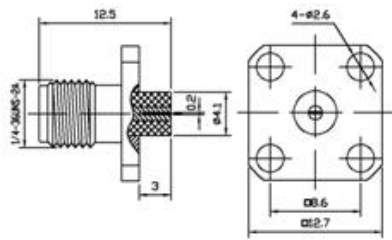

SMA-KFD40

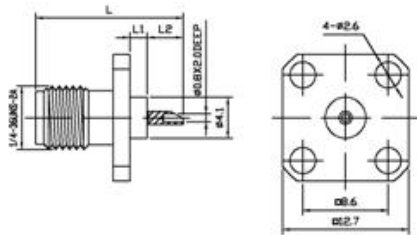

产品型号	L	L1	L2
SMA-KFD40	16.5	4.0	3.0
SMA-KFD80	14.7	2.4	2.8
SMA-KFD4-H3.2	16.5	4.0	3.2
SMA-KFD5-H1.5	16.5	5.5	1.5

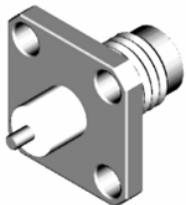

SMA-KFD68D

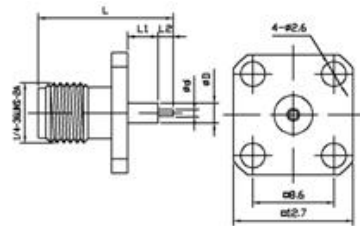

产品型号	L	L1	L2	D	d
SMA-KFD48-L	15.5	4.0	2.0	4.1	0.7
SMA-KFD-C2	19.5	8.5	1.5	4.1	1.0
SMA-KFD65-55	21.5	6.5	5.5	4.1	1.0
SMA-KFD68D	14.3	3.2	1.6	2.2	0.7
SMA-KFD68D-2	15.0	4.0	1.6	2.2	0.7

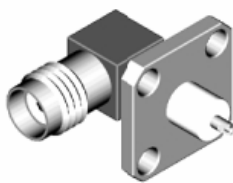

SMA-KWFD1

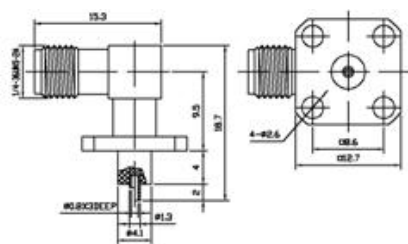

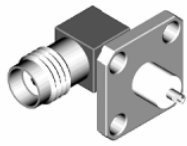

SMA-KWFD4

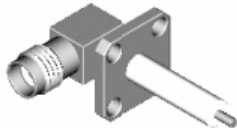
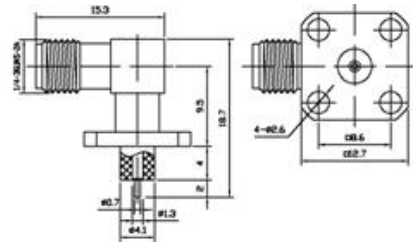

SMA-KWFD12

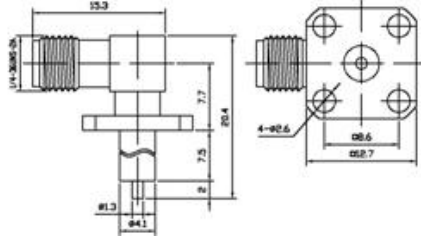

## 四孔法兰、金属穿墙类 4-Flange & Metal Wall



SMA-JFD18

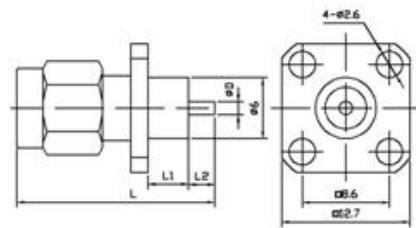

产品型号	L	L1	L2	D
SMA-JFD18	19.2	3.2	3.0	Ø1.3
SMA-JFD19	19.5	4.0	2.5	Ø1.3
SMA-JFD19-P4	18.3	4.0	1.6	Ø1.2
SMA-JFD27	17.9	2.4	2.5	Ø1.0
SMA-JFD30	17.3	3.0	1.6	Ø0.7

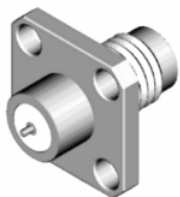

SMA-KFD19

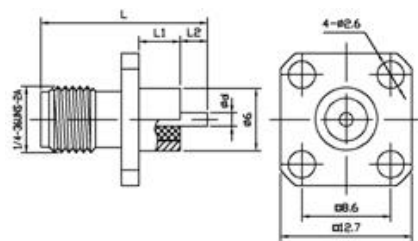

产品型号	L	L1	L2	d
SMA-KFD19	15.5	4.0	2.0	Ø1.3
SMA-KFD19P6	17.5	6.0	2.0	Ø1.3
SMA-KFD29	15.7	3.2	3.0	Ø1.3
SMA-KFD54	14.4	2.4	2.5	Ø1.0
SMA-KFD76	14.0	3.0	1.5	Ø0.7
SMA-KFD95	15.1	4.0	1.5	Ø0.8
SMA-KFD369	24.3	12.8	2.0	Ø1.3
SMA-KFD377	15.5	3.0	3.0	Ø1.3
SMA-KFD401	15.8	4.3	2.0	Ø1.3

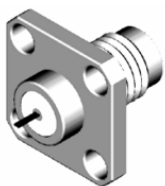

SMA-KFD19-P3225

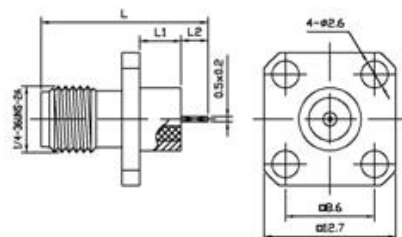

产品型号	L	L1	L2
SMA-KFD19-P3225	15.3	3.2	2.5
SMA-KFD19-P0425	16.1	4	2.5
SMA-KFD19-P0615	17	6	1.5

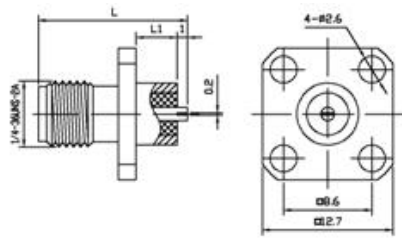

产品型号	L	L1	备注
SMA-KFD37	14.5	4.0	
SMA-KFD332	11.5	1.0	

SMA-KFD37

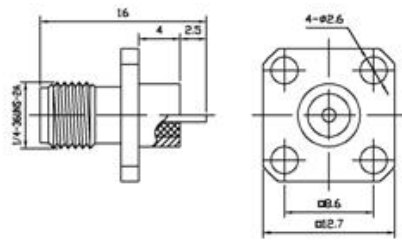
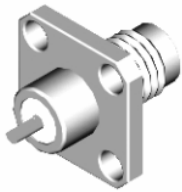

SMA-KFD90

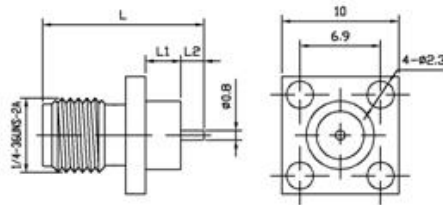

产品型号	L	L1	L2
SMA-KFD1069N	13.8	3.0	2.0
SMA-KFD1069A-P4	14.8	4.0	2.0

SMA-KFD1069N

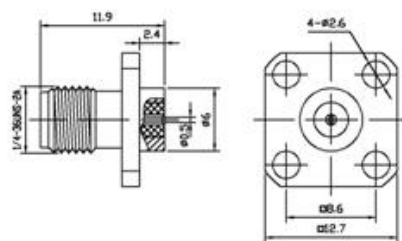
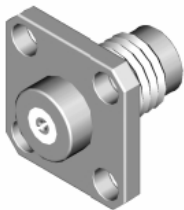

产品型号	备注
SMA-KFD308	适配插针 $\varnothing 0.4^{+0.09}_{-0.05}$

SMA-KFD308

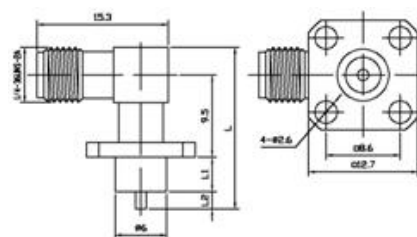
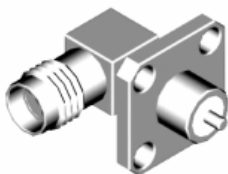

产品型号	L	L1
SMA-KWFD2	18.9	4.0
SMA-KWFD18	27.7	12.8

SMA-KWFD2



两孔法兰 2-Flange



SMA-KFD20

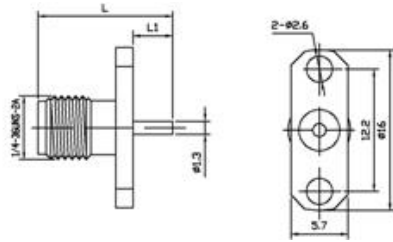

SMA-KFD24A

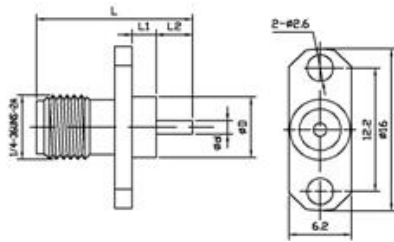

产品型号	L	L1	L2	d	D
SMA-KFD24A	14.7	3.0	2.2	Ø1.3	Ø5.2
SMA-KFD19A	15.5	4.0	2.0	Ø1.3	Ø6.0
SMA-KFD404	14.5	4.0	1.0	Ø0.8	Ø4.0

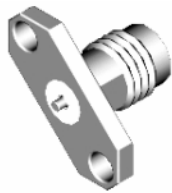

SMA-KFD48C

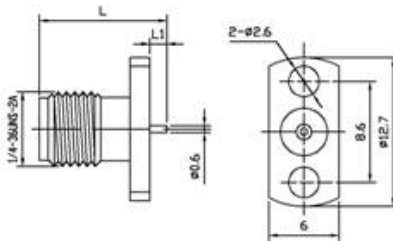

产品型号	L	L1
SMA-KFD48C	10.3	0.9
SMA-KFD340	11.0	1.5

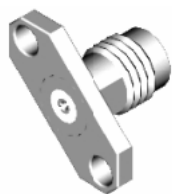

SMA-KFD56

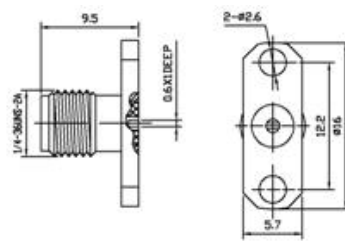

产品型号	备注
SMA-KFD56	内导体尾部开槽

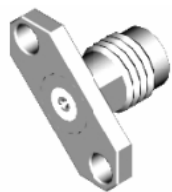

SMA-KFD71

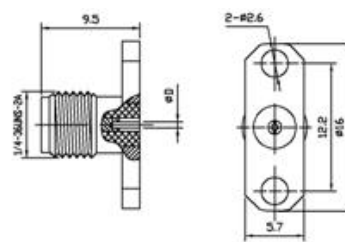

产品型号	D	备注
SMA-KFD71	0.6	
SMA-KFD72	0.4	
SMA-KFD191	0.8	
SMA-KFD92	0.9	

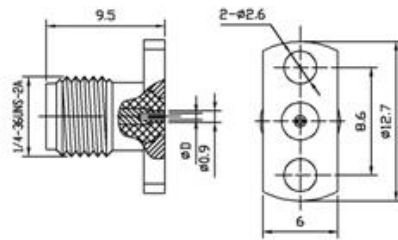

产品型号	备注
SMA-KFD72A	适配插针 $\phi 0.4_{-0}^{+0.05}$
SMA-KF72C	适配插针 $\phi 0.5_{-0}^{+0.05}$

SMA-KFD72A

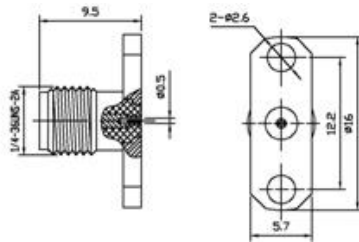
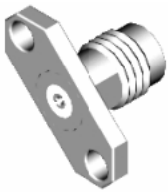

产品型号	D	L	备注
SMA-KFD72B	$\phi 0.5_{-0.02}^{+0.06}$	3.0	适配插针 $\phi 0.5_{-0.02}^{+0.01}$

SMA-KFD72B

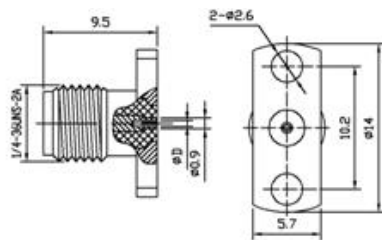

SMA-KFD75

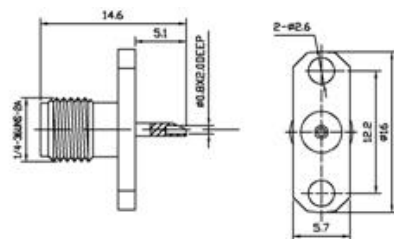

SMA-KFD86

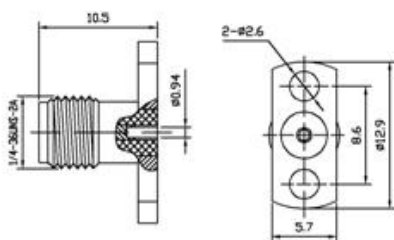
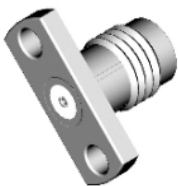

SMA-KKF-2X

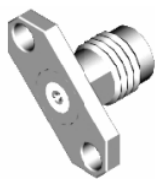

SMA-KKF-2

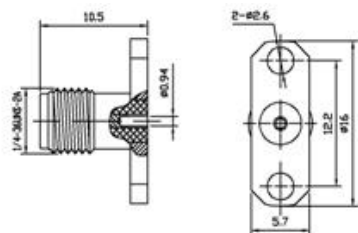

SMA-KKFC18

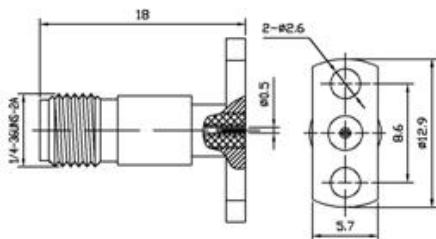

## 两孔法兰、介质穿墙类 2-Flange & Mail Wall



SMA-JFD

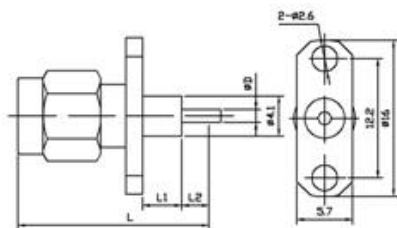

产品型号	L	L1	L2	D
SMA-JFD	25.4	8.6	4.0	Ø1.3
SMA-JFD23	18.7	2.0	4.0	Ø1.3
SMA-JFD28	20.9	5.2	9.0	Ø0.8



SMA-KFD3

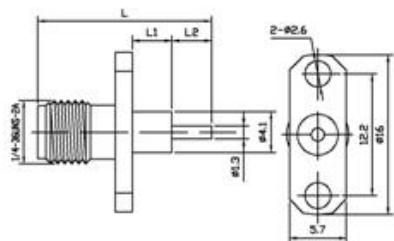

产品型号	L	L1	L2	产品型号	L	L1	L2
SMA-KFD3	27.4	15	3	SMA-KFD328	14.9	3.2	1.3
SMA-KFD5A	17.5	4	4	SMA-KFD339	16.5	5	2
SMA-KFD21	15.5	2	4	SMA-KFD64	27.5	15	3
SMA-KFD46	16.5	4	3	SMA-KFD348	11.5	0	2
SMA-KFD57	17.3	4.8	3	SMA-KFD376	21	8.3	3.2
SMA-KFD84	15.5	3	3	SMA-KFD384	17.8	3.2	5.1
SMA-KFD102	17.5	5	3	SMA-KFD385	17.8	5	3.3
SMA-KFD77	15.5	2	4	SMA-KFD386	19.4	6.1	3.8
SMA-KFD311	17.5	4.5	3.5	SMA-KFD393	16.5	5	2
SMA-KFD312	20.5	8	3	SMA-KFD84-1	14.5	3.0	2.0



SMA-KFD17

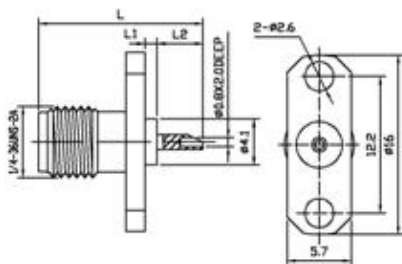

产品型号	L	L1	L2	备注
SMA-KFD17	14.6	1.1	4	
SMA-KFD21-A	14.8	2.6	2.7	
SMA-KFD100	16.5	4	3	
SMA-KFD353	17.5	5	3	

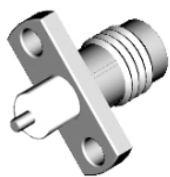

SMA-KFD72C

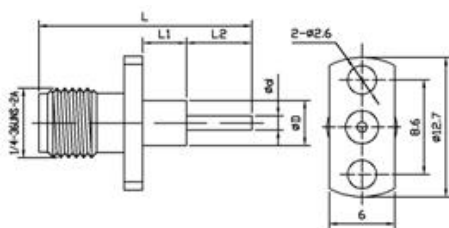

产品型号	L	L1	L2	d	D
SMA-KFD72C	14.5	3.0	2.0	0.7	4.1
SMA-KFD72D	15.5	4.0	2.0	1.27	4.1
SMA-KFD139	19.5	4.0	6.0	1.3	4.1
SMA-KFD139B	19.5	5.0	5.0	1.0	4.1
SMA-KFD139D	14.3	3.0	1.5	0.7	2.1



SMA-KFD98

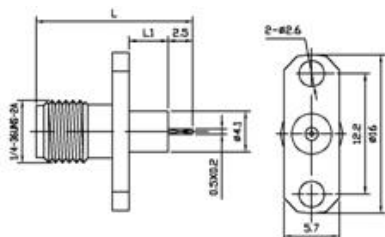

产品型号	L	L1
SMA-KFD98	15.2	3.2
SMA-KFD389	16.0	4.0

两孔法兰、金属穿墙类 2-Flange & Metal Wall

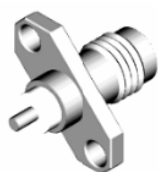

SMA-KFD24

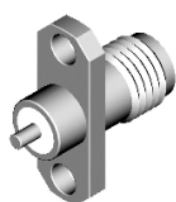
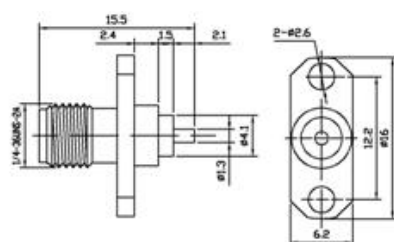

SMA-KFD24A

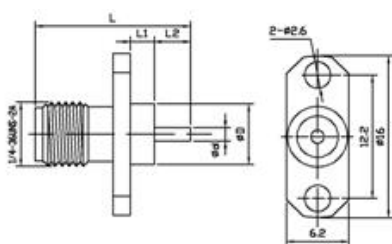

产品型号	L	L1	L2	d	D
SMA-KFD24A	14.7	3.0	2.2	Ø1.3	Ø5.2
SMA-KFD19A	15.5	4.0	2.0	Ø1.3	Ø6.0
SMA-KFD404	14.5	4.0	1.0	Ø0.8	Ø4.0
SMA-KFD197-2Z	21.7	4.0	2.0	Ø1.3	Ø6.0
SMA-KFD31-Z	14.5	4.0	1.0	Ø0.55	Ø4.0

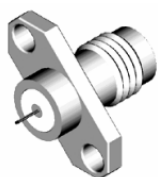

SMA-KFD31

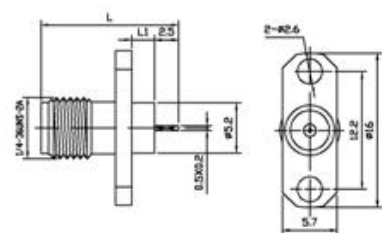

产品型号	备注
SMA-KFD31	扁与长边平行

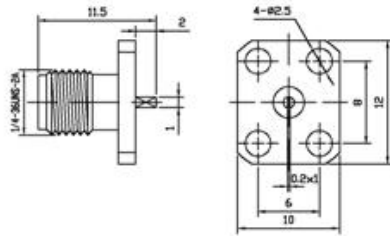
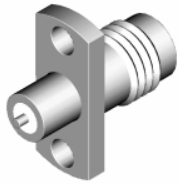

产品型号	备注
SMA-KFD412N	外壳镀镍

SMA-KFD412N

## 穿孔安装式终端连接器 Perforations Connectors with Solder End

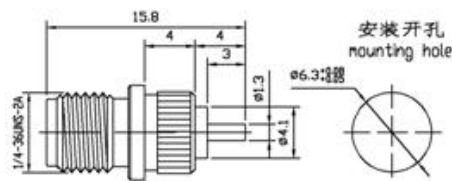

SMA-KPD1

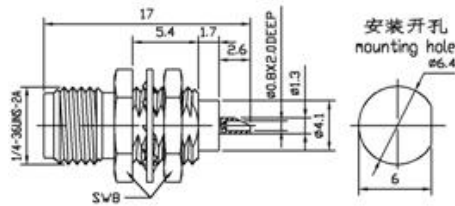

SMA-KYD

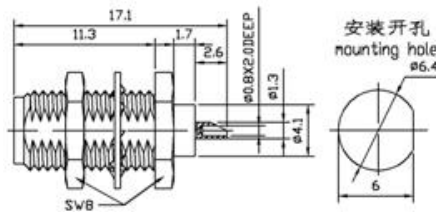

SMA-KYD21

## 系列内转接器 Within-Series Adapters

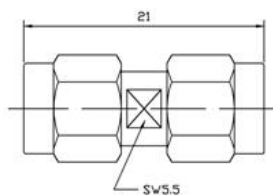

产品型号	备注
SMA-JJ	
SMA-JJG	不锈钢外壳、螺母

SMA-JJ



SMA-JK

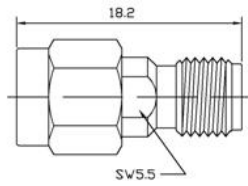

产品型号	备注
SMA-JK	
SMA-JKG	不锈钢外壳、螺母

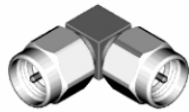

SMA-JWJ

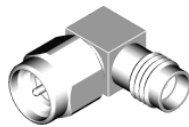
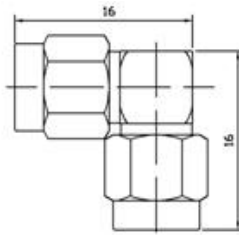

SMA-JWK

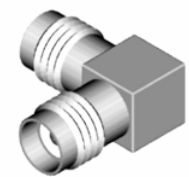
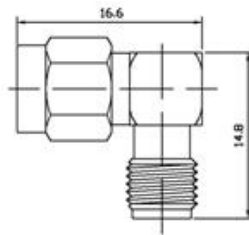

SMA-KWK

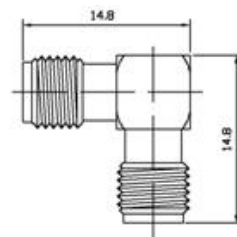

SMA-KYK

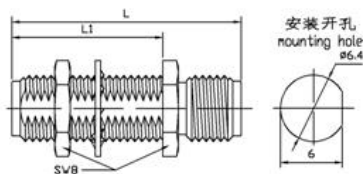

产品型号	L	L1	备注
SMA-KYK	22.2	14.6	
SMA-KYK2	18.0	10.2	不锈钢外壳
SMA-KYKG	22.0	14.6	

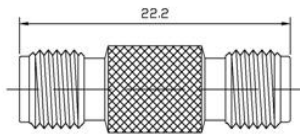
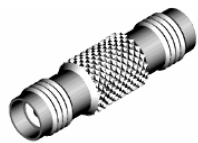

SMA-KK1

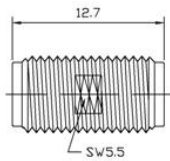

SMA-KK

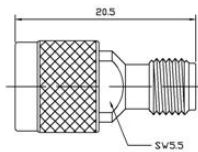

SMA-(SE)KJ

产品型号	备注
SMA-(SE)KJ	滑入式插头